

---

## Table of Contents

---

### LIFT TRUCK

CLS-420 Wired Version  
*Cargo Lift Scale* ..... **LT-2**

CLS-420 Wireless Version  
*Cargo Lift Scale* ..... **LT-4**

CLS-920j® Wired Version  
*Cargo Lift Scale* ..... **LT-6**

CLS-920j® Wireless Version  
*Cargo Lift Scale* ..... **LT-8**

### PALLET JACK

Intercomp PW800™  
*Pallet Truck Scales*..... **LT-10**



# Lift Truck/Pallet Jack

## CLS-420 Wired Version

Cargo Lift Scale

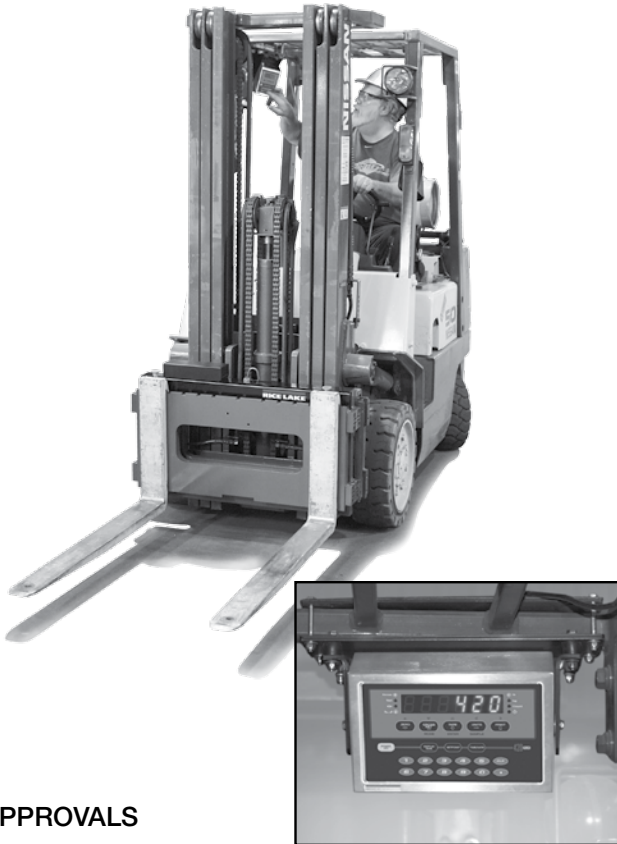

### STANDARD FEATURES

- Capacities: 5,000 lb or 8,000 lb
- Two 5,000 lb stainless steel load cells
- Mechanical overload stops promote scale longevity and accuracy
- Reinforced cover plate protects load cells and junction box from debris
- Welded centering pin ensures proper alignment and prevents scale from lateral movement
- Two-channel iQUBE® 2
- Cal-Match™ algorithm automatically trims and calibrates scale
- Coiled interface cable from scale to indicator

### 420 Plus Indicator

- Stainless steel enclosure
- Two-piece mounting assembly with vibration isolators
- Six digit, 0.8in red LED display
- Full numeric keypad for manual tare entry
- Accumulate weight function for multiple skid loads
- RS-232 port (time and date, weight)
- Full front panel digital calibration
- On/Off button for forklift battery conservation

### APPROVALS



### SPECIFICATIONS

#### SCALE CAPACITY:

5,000lb, 8,000lb

#### SCALE POWER:

Supplied by indicator through coiled interface cable

#### SCALE MATERIAL/FINISH:

Painted Mild Steel

#### APPROVAL:

NTEP Certified per H-44 at 1,000 divisions, Class III, COC # 06-074 (5,000lb only)

#### 420 PLUS DISPLAY:

0.8in (20mm), 6-digit Super Red Light Emitting Diode (LED), 7-segment digits

#### 420 POWER - DC:

Line voltages: 10-60VDC DC input  
Power consumption: 0.75A Max  
Fused at 5.0A

#### 420 STATUS ANNUNCIATORS:

Designators for: center of zero, stand still, gross, net, lb, kg, count, tare

#### 420 OPERATING TEMPERATURE:

Legal: 14°F to 104°F  
(-10°C to 40°C)  
Industrial: 14°F to 122°F  
(-10°C to 50°C)

#### WARRANTY:

Two-year limited warranty

## CLS-420 Wired Version

Cargo Lift Scale

PART #	SIZE, CAPACITY	FORKLIFT COMPATIBILITY	WEIGHT	PRICE
CLS Forklift Scale, 420 wired version				
111033.....	28 in, 5,000lb.....	Class II, 16 in cleat style carriage.....	524 lb .....	\$6,550.00
96339.....	34 in, 5,000lb.....	Class II, 16 in cleat style carriage.....	539 lb .....	6,550.00
111038* .....	38 in, 8,000lb.....	Class III, 20 in cleat style carriage.....	1144 lb .....	7,950.00

\*Non-NTEP

### OPTIONS/ACCESSORIES

112986..... Wireless LAN card 802.11 B/G..... 550.00

### Manuals

96483..... CLS-420 installation manual ..... 20.00

96484..... CLS-420 operator card..... 10.00

### CLS SCALE DIMENSIONS

Front view

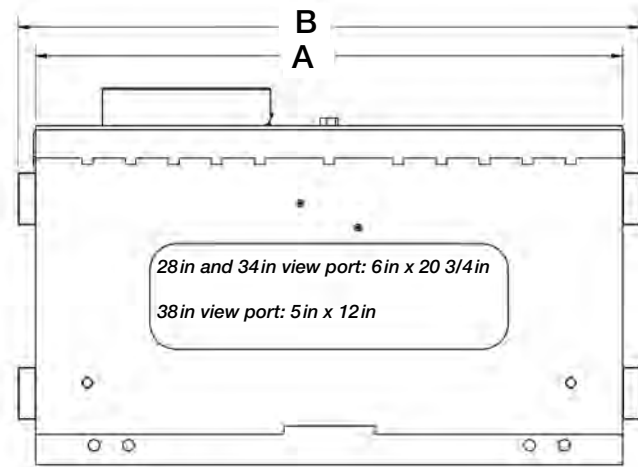

Side view

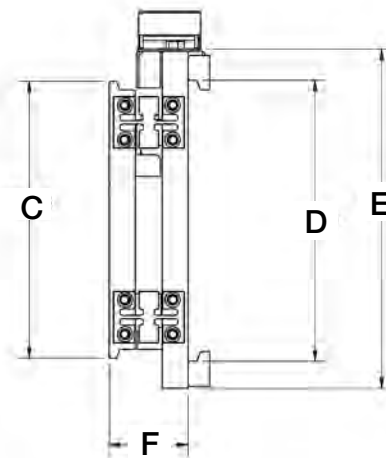

Rear view

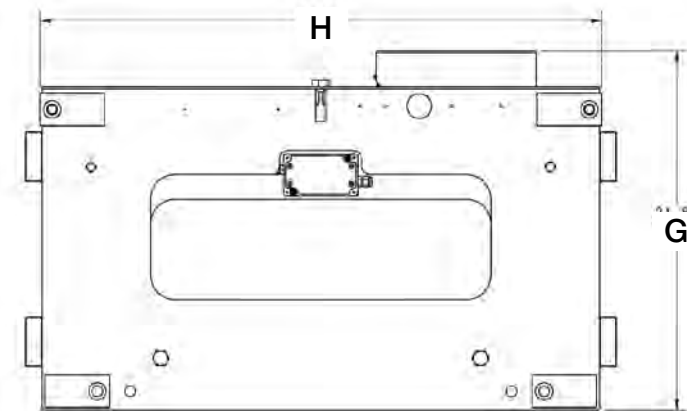

Scale Size	A	B	C	D	E	F	G	H
<b>28 in, 5000 lb</b>	28	30	16	16.29	19.50	4.49	21.80	28.24
<b>34 in, 5000 lb</b>	34	36	16	16.29	19.50	4.49	21.80	34.24
<b>38 in, 8000 lb</b>	38	40	20	20.15	24.50	6.04	26.68	38

## CLS-420 Wireless Version

Cargo Lift Scale

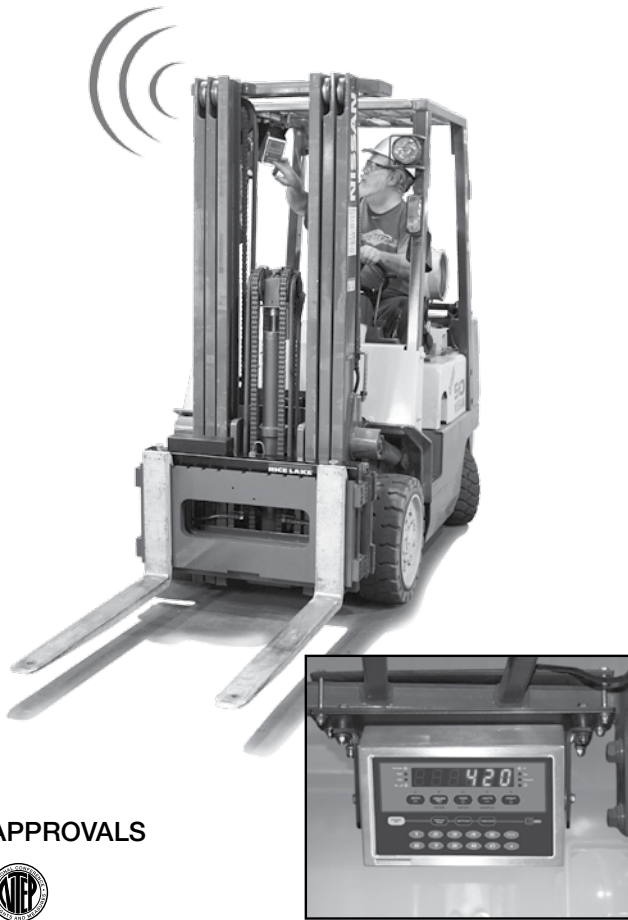

### STANDARD FEATURES

- Capacities: 5,000lb or 8,000lb
- Two 5,000lb stainless steel load cells
- Mechanical overload stops promote scale longevity and accuracy
- Reinforced cover plate protects load cells and junction box from debris
- Welded centering pin ensures proper alignment and prevents scale from lateral movement
- Two-channel iQUBE®2
- Cal-Match™ algorithm automatically trims and calibrates scale
- ZigBee™ connection from scale to indicator
- Two lithium-ion smart batteries included  
Note: scale operates using one battery for 24 continuous hours and requires only eight hours to fully charge
- External battery charger

### 420 Plus Indicator

- Stainless steel enclosure
- Two-piece mounting assembly with vibration isolators
- Six digit, 0.8in red LED display
- Full numeric keypad for manual tare entry
- Accumulate weight function for multiple skid loads
- RS-232 port (time and date, weight)
- Full front panel digital calibration
- On/Off button for forklift battery conservation

### APPROVALS



### SPECIFICATIONS

#### SCALE CAPACITY:

5,000lb, 8,000lb

#### SCALE POWER:

Supplied by indicator through coiled interface cable

#### SCALE MATERIAL/FINISH:

Painted Mild Steel

#### APPROVAL:

NTEP Certified per H-44 at 1,000 divisions, Class III, COC # 06-074 (5,000lb only)

#### 420 PLUS DISPLAY:

0.8in (20mm), 6-digit Super Red Light Emitting Diode (LED), 7-segment digits

#### 420 POWER - DC:

Line voltages: 10-60VDC DC input  
Power consumption: 0.75A Max  
Fused at 5.0A

#### 420 STATUS ANNUNCIATORS:

Designators for: center of zero, stand still, gross, net, lb, kg, count, tare

#### 420 OPERATING TEMPERATURE:

Legal: 14°F to 104°F  
(-10°C to 40°C)  
Industrial: 14°F to 122°F  
(-10°C to 50°C)

#### WARRANTY:

Two-year limited warranty

## CLS-420 Wireless Version

Cargo Lift Scale

PART #	SIZE, CAPACITY	FORKLIFT COMPATIBILITY	WEIGHT	PRICE
CLS Forklift Scale, 420 wireless version				
111034.....	28in, 5,000lb.....	Class II, 16 in cleat style carriage.....	524 lb .....	\$7,815.00
96340.....	34 in, 5,000lb.....	Class II, 16 in cleat style carriage.....	539 lb .....	7,815.00
111039* .....	38in, 8,000lb.....	Class III, 20 in cleat style carriage.....	1144 lb .....	9,215.00

\*Non-NTEP

### OPTIONS/ACCESSORIES

112986..... Wireless LAN card 802.11 B/G..... 550.00

### Manuals

96483..... CLS-420 installation manual ..... 20.00

96484..... CLS-420 operator card..... 10.00

96315..... CLS series service & troubleshooting manual..... 35.00

### CLS SCALE DIMENSIONS

Front view

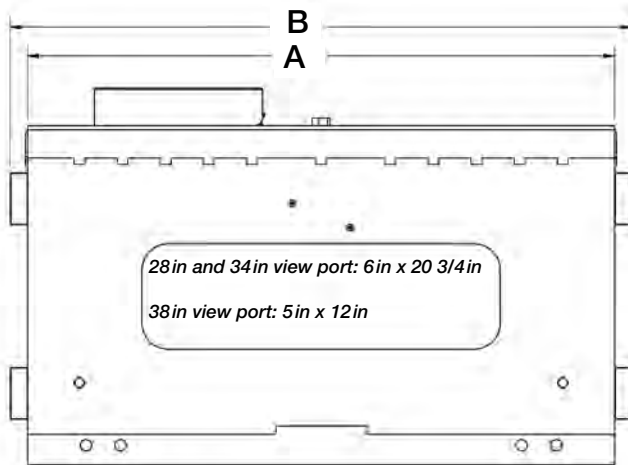

Side view

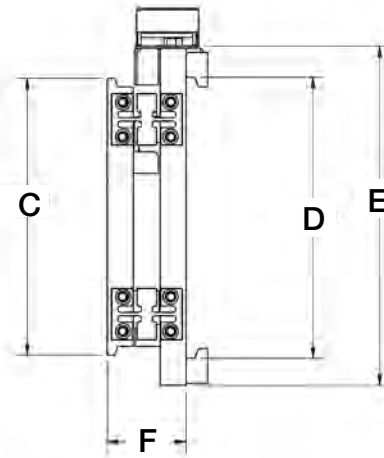

Rear view

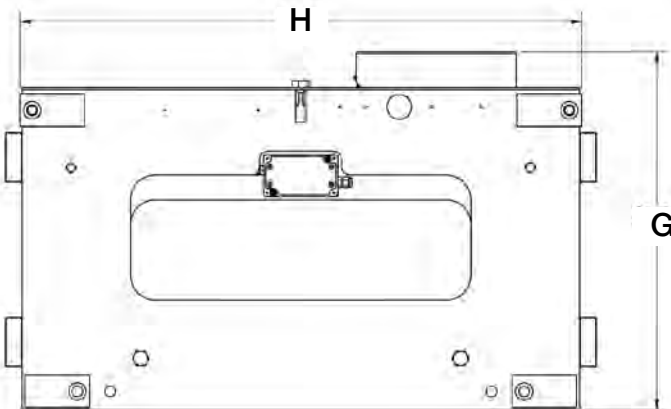

Scale Size	A	B	C	D	E	F	G	H
<b>28 in, 5000 lb</b>	28	30	16	16.29	19.50	4.49	21.80	28.24
<b>34 in, 5000 lb</b>	34	36	16	16.29	19.50	4.49	21.80	34.24
<b>38 in, 8000 lb</b>	38	40	20	20.15	24.50	6.04	26.68	38

Lift Truck Scales

## CLS-920i® Wired Version

Cargo Lift Scale

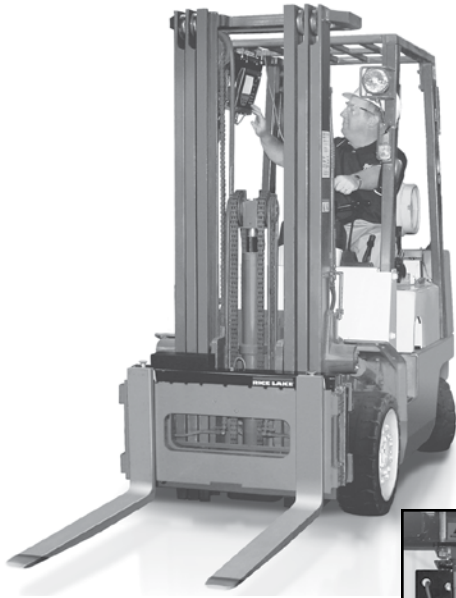

### STANDARD FEATURES

- Capacities: 5,000lb, 8,000lb
- Two 5,000lb stainless steel load cells
- Mechanical overload stops promote scale longevity and accuracy
- Reinforced cover plate protects load cells and junction box from debris
- Welded centering pin ensures proper alignment and prevents scale from lateral movement
- Two-channel iQUBE®2
- Cal-Match™ algorithm automatically trims and calibrates scale
- Coiled interface cable from scale to indicator

### 920i® Indicator

- Stainless steel enclosure
- Two-piece mounting assembly with vibration isolators
- 4.6in W x 3.4in H, back-lit LCD graphical display (320 x 240 pixels)
- User program with data collection and transaction storage including: pro number, pro open/closed, employee ID, last transaction, time and date, actual weight and number of skids
- Internal memory of 1 MB for transaction records
- Diagnostics to indicate excessive drift, A/D failures, connection errors, excitation voltage shifts and more
- On/Off toggle switch for forklift battery conservation

### APPROVALS



### SPECIFICATIONS

#### SCALE CAPACITY:

5,000lb, 8,000lb

#### SCALE POWER:

Supplied by indicator through coiled interface cable

#### SCALE MATERIAL/FINISH:

Painted Mild Steel

#### APPROVAL:

NTEP Certified per H-44 at 1,000 divisions, Class III, COC # 06-074 (5,000lb only)

#### 920i DISPLAY:

4.6in W x 3.4in H (116mm W x 86mm H), 320 x 240 pixel VGA Liquid Crystal Display (LCD) module with adjustable contrast

#### 920i POWER - DC:

Line voltages: 10-60VDC DC input  
Power consumption: 1.5A Max  
Fused at 5.0A

#### 920i OPERATING TEMPERATURE:

Legal: 14°F to 104°F  
(-10°C to +40°C)  
Industrial: 14°F to 122°F (-10°C to +50°C)

#### WIRELESS LAN OPTION:

Contains FCC ID: R68WIPORATG  
Range: Up to 328 ft indoors  
Operating Frequency: ISM 2.4 GHz

#### WARRANTY:

Two-year limited warranty

## CLS-920i® Wired Version

Cargo Lift Scale

PART #	SIZE, CAPACITY	FORKLIFT COMPATIBILITY	WEIGHT	PRICE
<b>CLS Forklift Scale, 920i Wired Version</b>				
111035.....	28in, 5,000lb.....	Class II, 16 in cleat style carriage.....	524lb.....	\$7,100.00
96341.....	34in, 5,000lb.....	Class II, 16 in cleat style carriage.....	539lb.....	7,100.00
111040*.....	38in, 8,000lb.....	Class III, 20 in cleat style carriage.....	1144lb.....	8,450.00

\*Non-NTEP

### OPTIONS/ACCESSORIES

96355.....	Wireless LAN card 802.11 B/G.....	575.00
72704.....	USB to serial converter (used to configure wireless LAN card if PC does not have serial port).....	70.00
97480.....	Optional bar code scanner kit for 920i (Symbol model MS-3204 omnidirectional and mounting hardware).....	575.00
99445.....	Indicator corner protection kit (includes corner pads with adhesive strips).....	15.00

### Manuals

96312.....	CLS-920i installation manual.....	20.00
96313.....	CLS-920i operator card.....	10.00

### CLS SCALE DIMENSIONS

Front view

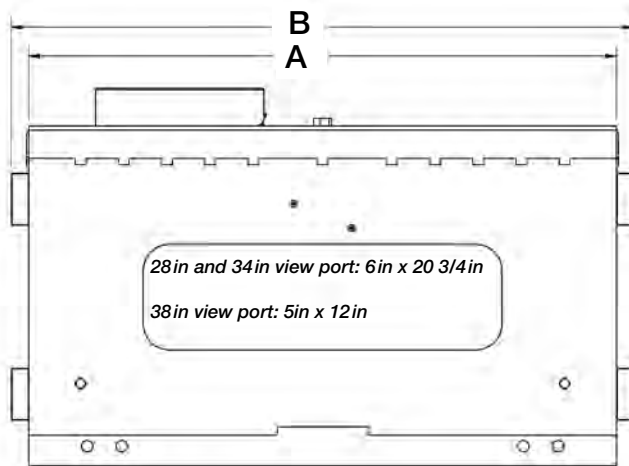

Side view

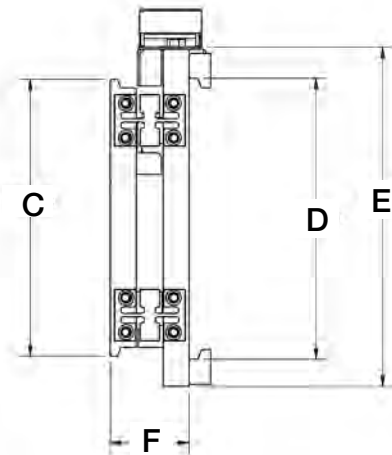

Rear view

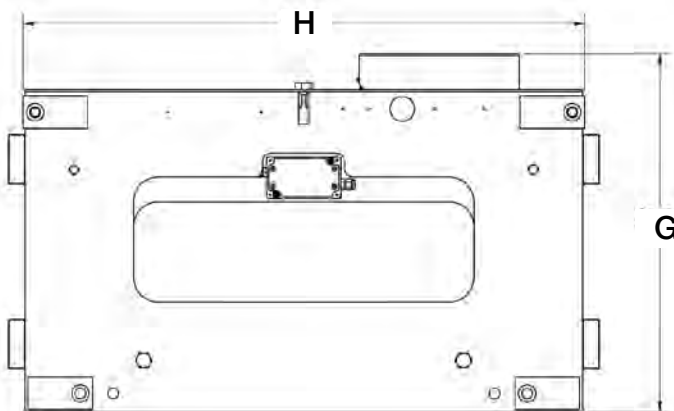

Scale Size	A	B	C	D	E	F	G	H
<b>28 in, 5000 lb</b>	28	30	16	16.29	19.50	4.49	21.80	28.24
<b>34 in, 5000 lb</b>	34	36	16	16.29	19.50	4.49	21.80	34.24
<b>38 in, 8000 lb</b>	38	40	20	20.15	24.50	6.04	26.68	38

# Lift Truck/Pallet Jack

## CLS-920i® Wireless Version

Cargo Lift Scale

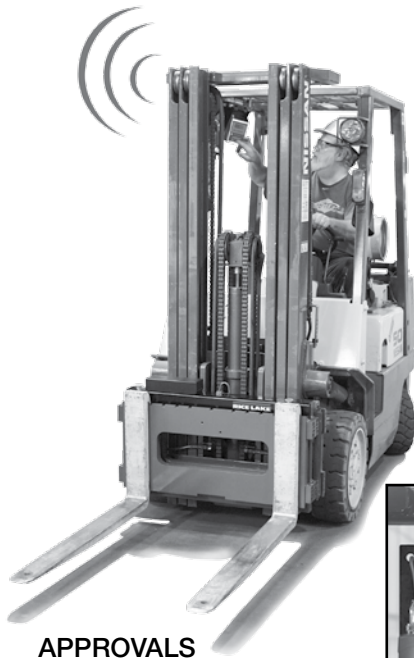

APPROVALS



### STANDARD FEATURES

- Capacities: 5,000lb, 8,000lb
- Two 5,000lb stainless steel load cells
- Mechanical overload stops promote scale longevity and accuracy
- Reinforced cover plate protects load cells and junction box from debris
- Welded centering pin ensures proper alignment and prevents scale from lateral movement
- Two-channel iQUBE®2
- Cal-Match™ algorithm automatically trims and calibrates scale
- ZigBee™ connection from scale to indicator
- Two lithium-ion smart batteries included  
Note: scale operates using one battery for 24 continuous hours and requires only eight hours to fully charge
- External battery charger

### 920i® Indicator

- Stainless steel enclosure
- Two-piece mounting assembly with vibration isolators
- 4.6in W x 3.4in H, back-lit LCD graphical display (320 x 240 pixels)
- User program with data collection and transaction storage including: pro number, pro open/closed, employee ID, last transaction, time and date, actual weight and number of skids
- Internal memory of 1MB for transaction records
- Diagnostics to indicate excessive drift, A/D failures, connection errors, excitation voltage shifts and more
- On/Off toggle switch for forklift battery conservation

ZigBee™ is a trademark of the ZigBee Alliance

### SPECIFICATIONS

#### SCALE CAPACITY:

5,000lb, 8,000lb

#### SCALE POWER:

Supplied by indicator through coiled interface cable

#### SCALE MATERIAL/FINISH:

Painted Mild Steel

#### APPROVAL:

NTEP Certified per H-44 at 1,000 divisions, Class III, COC # 06-074 (5,000lb only)

#### 920i DISPLAY:

4.6in W x 3.4in H (116mm W x 86mm H), 320 x 240 pixel VGA Liquid Crystal Display (LCD) module with adjustable contrast

#### 920i POWER - DC:

Line voltages: 10-60VDC DC input  
Power consumption: 1.5A Max  
Fused at 5.0A

#### 920i OPERATING TEMPERATURE:

Legal: 14°F to 104°F  
(-10°C to +40°C)  
Industrial: 14°F to 122°F (-10°C to +50°C)

#### WIRELESS LAN OPTION:

Contains FCC ID: R68WIPORATG  
Range: Up to 328 ft indoors  
Operating Frequency: ISM 2.4 GHz

#### WARRANTY:

Two-year limited warranty

## CLS-920i® Wireless Version

Cargo Lift Scale

PART #	SIZE, CAPACITY	FORKLIFT COMPATIBILITY	WEIGHT	PRICE
<b>CLS Forklift Scale, 920i Wireless Version</b>				
111036.....	28 in, 5,000 lb.....	Class II, 16 in cleat style carriage.....	.524 lb .....	\$8,365.00
96342.....	34 in, 5,000 lb.....	Class II, 16 in cleat style carriage.....	.539 lb .....	8,365.00
111041* .....	38 in, 8,000 lb.....	Class III, 20 in cleat style carriage.....	1144lb .....	9,715.00

\*Non-NTEP

### OPTIONS/ACCESSORIES

96355.....	Wireless LAN card .....	575.00
72704.....	USB to serial converter (used to configure wireless LAN card if PC does not have serial port) .....	70.00
97480.....	Optional bar code scanner kit for 920i (Symbol model MS-3204 omnidirectional and mounting hardware) .....	575.00
99445.....	Indicator corner protection kit (includes corner pads with adhesive strips) .....	15.00

### Manuals

96312.....	CLS-920i installation manual.....	20.00
96313.....	CLS-920i operator card .....	10.00

### CLS SCALE DIMENSIONS

Front view

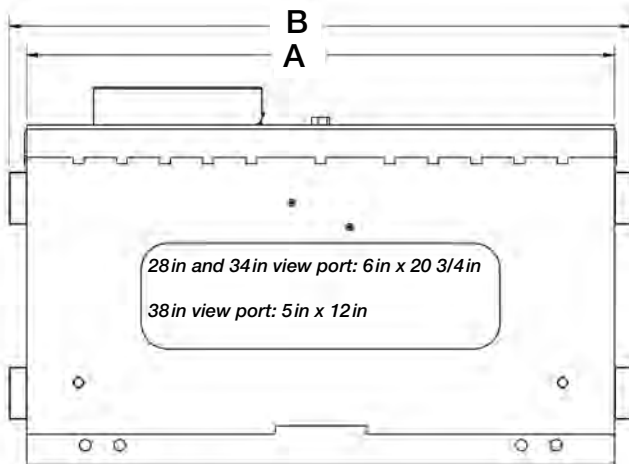

Side view

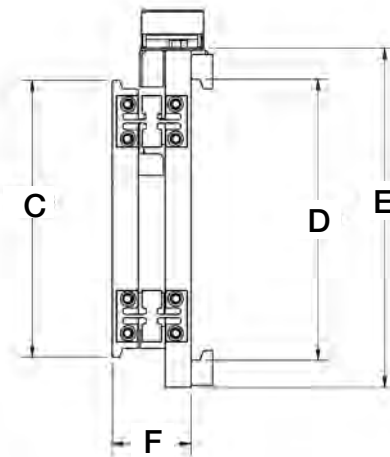

Rear view

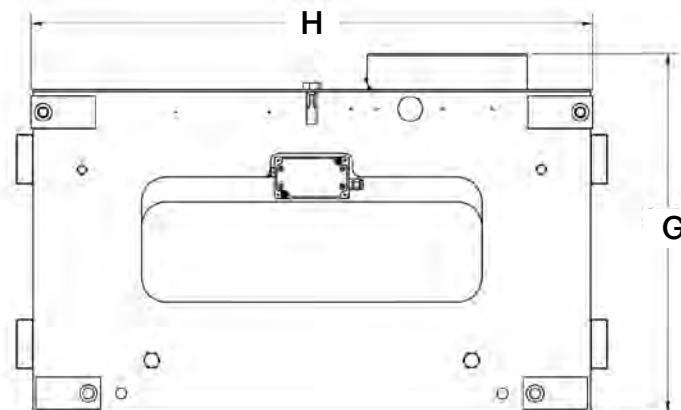

Scale Size	A	B	C	D	E	F	G	H
<b>28 in, 5000 lb</b>	28	30	16	16.29	19.50	4.49	21.80	28.24
<b>34 in, 5000 lb</b>	34	36	16	16.29	19.50	4.49	21.80	34.24
<b>38 in, 8000 lb</b>	38	40	20	20.15	24.50	6.04	26.68	38

# Lift Truck/Pallet Jack

## Intercomp PW800™

## Pallet Truck Scales



Rechargeable nickel-cadmium cells  
(3 batteries per stick)

Charger/power transformer

### STANDARD FEATURES

- Includes charger and 9 "D" size NiCad batteries
- Fast, low-cost parts counting for taking inventory
- Count totalization up to 1 million counts
- Accuracy of ± 0.1%
- Tare: up to 100% of capacity
- Zero: up to 100% of capacity
- Units of measure: lb/kg
- 5,000lb capacity in one-pound increments
- Push-button print of gross, net, tare, total and count total
- Displays gross, net and tare weight
- Weight totalization up to 100,000lb
- Adjustable baud rates from 75 to 9600
- Quick verification of incoming/outgoing freight
- Instant check of truck loading by weight
- Large, easy-to-read 0.8in six-digit LED (Light Emitting Diode) display
- Adjustable display update/weight averaging
- Selectable AZT off, 0.6, 1, or 3 graduations
- Mild steel

### APPROVALS

Measurement  
Canada  
Approved  
(Pending)

### SPECIFICATIONS

#### CAPACITY:

5,000lb (2,500kg)

#### GRADUATION:

1 lb (.5kg)

#### ACCURACY:

± 0.1% of reading

#### BATTERY LIFE:

Up to 25 hours of continuous use

#### BATTERIES:

Nine D size rechargeable nickel-cadmium cells

#### CHARGE TIME:

16 hours

#### CHARGE:

Charger/power transformer — 120/220VAC

#### LOW BATTERY SHUT-OFF:

Unit automatically shuts off if batteries are low

#### AUTO SHUT-OFF:

Shuts off after up to five minutes of non-use (variable up to 30 min)

#### DISPLAY:

0.8in (20mm) high — 5 1/2-digit LED (Light Emitting Diode)  
Indicators:

Six (lb, kg, net, tare, total, count)

#### CONTROL SWITCHES:

Eight (on, off, set mode, print, tare, zero, lb/kg)

#### HUMIDITY:

10 to 95% non-condensing

#### TEMPERATURE:

Operating: -20°C to 60°C (-4°F to 140°F)

#### FORK DIMENSIONS:

**PW800-2748:** 48in x 27in x 2.9in (1219mm x 686mm x 74mm)

**PW800-2148:** 48in x 21in x 2.9in (1219mm x 533mm x 74mm)

#### EST. SHIP WEIGHT:

300lbs (136kg)

#### WARRANTY:

One-year limited warranty

PART #	MODEL	FORK SIZE	CAPACITY	EST. SHIP WEIGHT	PRICE
43659*	PW800-2748	48in x 27in x 2.9in	5,000lb	300lb	\$3,348.00
43660*	PW800-2148	48in x 21in x 2.9in	5,000lb	300lb	3,348.00

### OPTIONS/ACCESSORIES

43946..... RS-232 serial output..... 195.00

\*Includes pallet truck, 120V/220V charger, nine D size Nicads